

ONE PACIFIC RESIDENCE  
MACTAN ISLAND





MACTAN SHRINE

PUNTA ENGANO ROAD

MACTAN CIRCUMFERENTIAL ROAD

PENINSULA DRIVE

COUNTRY CLUB DISTRICT

GARDEN DISTRICT

ONE WORLD CENTER

8 NEWTOWN BOULEVARD

SOUTHVIEW ROAD

NEWTOWN BOULEVARD

ONE PACIFIC RESIDENCE

MACTAN RICHMONDE HOTEL

FUTURE MIXED USE DEVELOPMENT

SHANGRI-LA RESORT & SPA

SHANGRI-LA RESORT & HOTEL

PORTOFINO BEACH RESORT

For Future Development

For Future Development

ONE PACIFIC RESIDENCE  
MACTAN ISLAND

**THE MACTAN NEWTOWN  
MASTER DEVELOPMENT PLAN**

HILUTUNGAN CHANNEL



ONE PACIFIC RESIDENCE  
MACTAN ISLAND







UNIT G  
1-BEDROOM  
A=42.00m<sup>2</sup>  
BAL=2.90m

UNIT H  
1-BEDROOM  
A=41.90m<sup>2</sup>  
BAL=2.70m

UNIT I  
1-BEDROOM  
A=41.90m<sup>2</sup>  
BAL=2.70m

ONE PACIFIC RESIDENCE  
TOWER C

UNIT F  
EXECUTIVE STUDIO  
A=53.80m<sup>2</sup>  
BAL=2.90m

UNIT E  
1-BEDROOM  
A=43.00m<sup>2</sup>  
BAL=2.80m

UNIT D  
1-BEDROOM  
A=41.90m<sup>2</sup>  
BAL=2.70m

UNIT C  
1-BEDROOM  
A=41.90m<sup>2</sup>  
BAL=2.70m

UNIT B  
1-BEDROOM  
A=41.90m<sup>2</sup>  
BAL=2.70m

UNIT A  
1-BEDROOM  
A=41.90m<sup>2</sup>  
BAL=2.70m

ONE PACIFIC RESIDENCE  
TOWER B

UNIT 10  
EXECUTIVE STUDIO  
A=53.80m<sup>2</sup>  
BAL=2.90m

UNIT 9  
1-BEDROOM  
A=43.00m<sup>2</sup>  
BAL=2.80m

UNIT 8  
1-BEDROOM  
A=41.90m<sup>2</sup>  
BAL=2.70m

UNIT 7  
1-BEDROOM  
A=41.90m<sup>2</sup>  
BAL=2.70m

UNIT 6  
1-BEDROOM  
A=41.90m<sup>2</sup>  
BAL=2.70m

UNIT 5  
1-BEDROOM  
A=41.90m<sup>2</sup>  
BAL=2.70m

UNIT 4  
1-BEDROOM  
A=41.90m<sup>2</sup>  
BAL=2.70m

UNIT 3  
1-BEDROOM  
A=41.90m<sup>2</sup>  
BAL=2.70m

ONE PACIFIC RESIDENCE  
TOWER A

UNIT 2  
1-BEDROOM  
A=41.90m<sup>2</sup>  
BAL=2.70m

UNIT 1  
1-BEDROOM  
A=41.90m<sup>2</sup>  
BAL=2.70m

UNIT 0  
1-BEDROOM  
A=41.90m<sup>2</sup>  
BAL=2.70m

UNIT -1  
1-BEDROOM  
A=41.90m<sup>2</sup>  
BAL=2.70m

PACIFIC WORLD  
TOWER

8 NEWTOWN BLVD.

NEWTOWN BOULEVARD

ONE PACIFIC RESIDENCE





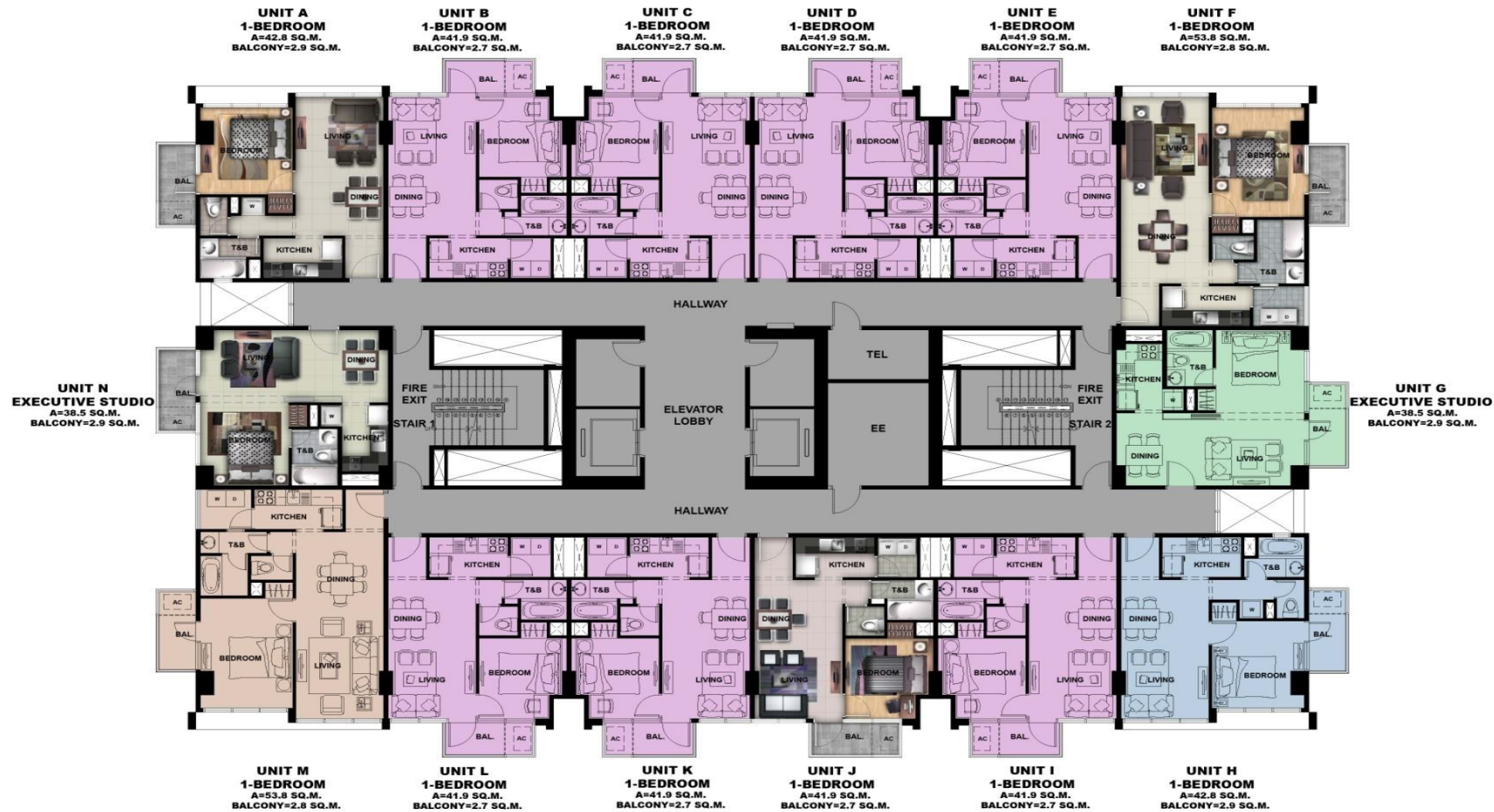

**ONE** PACIFIC RESIDENCE  
MACTAN ISLAND  
**TYPICAL 7TH, 9TH, 11TH, 14TH & 16TH FLOOR PLAN**  
**TOWER A,B&C**

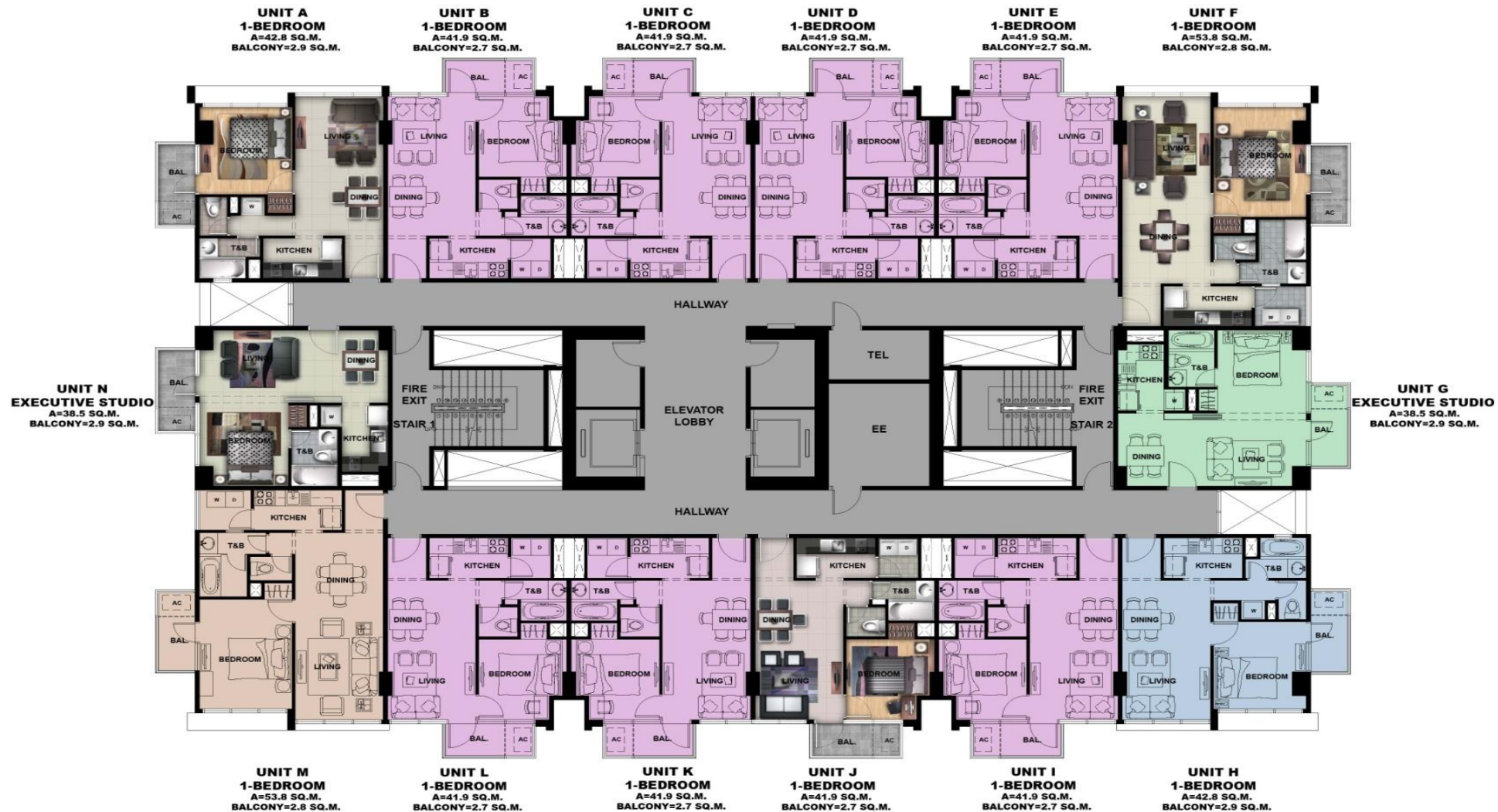

ONE PACIFIC RESIDENCE  
MACTAN ISLAND

TYPICAL 8TH, 10TH, 12TH, 15TH & 17TH FLOOR PLAN  
TOWER A,B&C



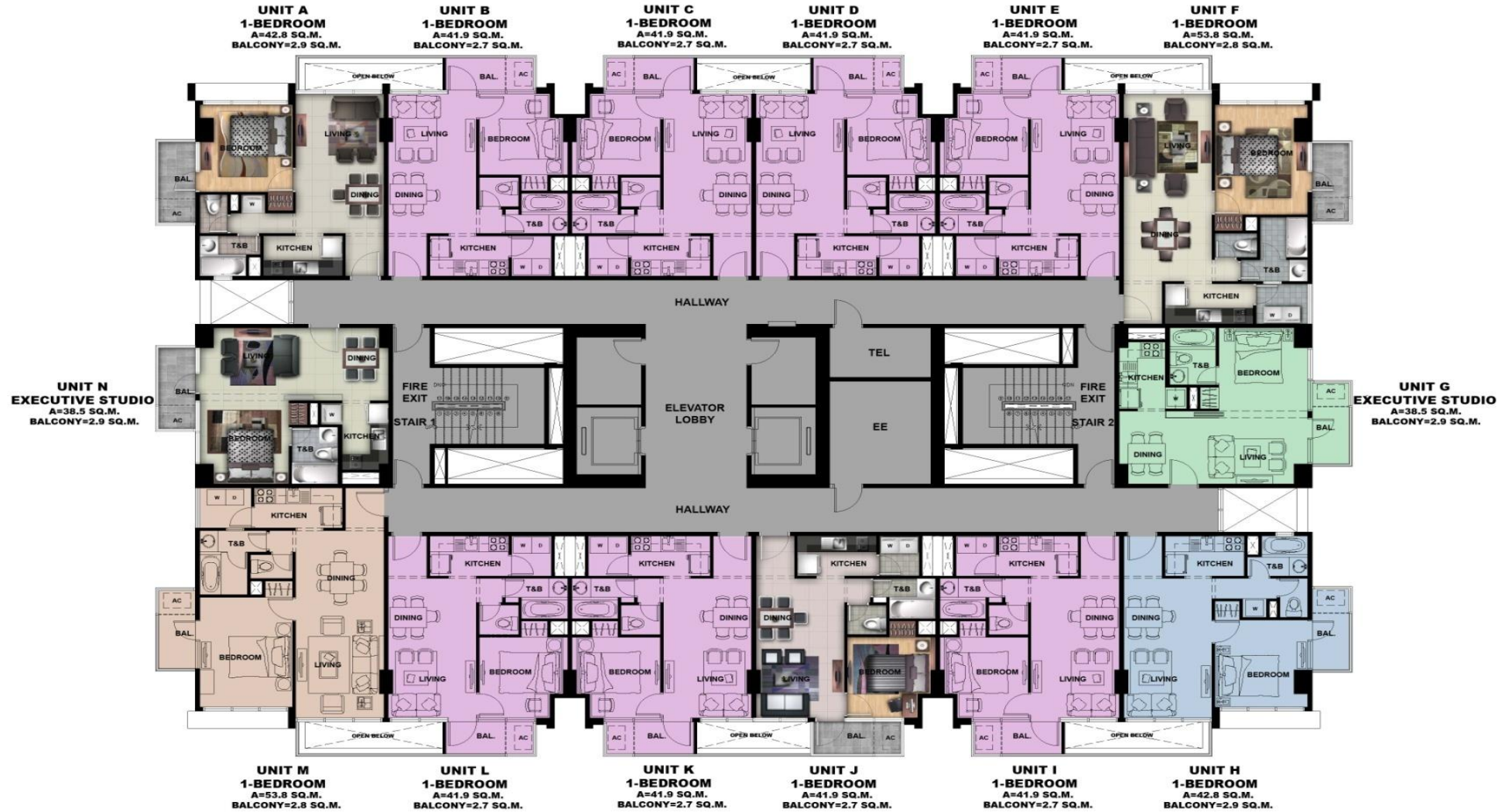





## Basic Details:

**Total Land Area**

12, 415.85 sqm

**Total Gross Floor Area**

94,238.7

**Exterior Paint Color and Finish of the Tower**

Painted white & gray concrete walls- Residential Glass curtain wall

**Architects and Consultants**

Design Alliance





Interior Unit Feature:	
Unit Types Available	1 Bedroom and Executive Studio
Total No. of Units per Floor	14 units
Minimum Floor Area	38.5 + 2.9 sqm balcony
Maximum Floor Area	53.8 + 2.8 sqm balcony
Floor-to-floor Height	3.2 m
Floor-to-ceiling Height	2.4 m
Security Provisions and Location of CCTV	All lobby areas and Residential Hallway



# ONE PACIFIC RESIDENCE

MACTAN ISLAND

## **Unit type and Floor Plan**





ONE PACIFIC RESIDENCE  
MACTAN ISLAND

## 1-BEDROOM

A=42.8 SQ.M.

BALCONY=2.9 SQ.M.

### UNIT A & H (TOWER A,B&C)

TYPICAL 7TH, 9TH, 11TH, 14TH & 16TH FLOOR PLAN  
TYPICAL 8TH, 10TH, 12TH, 15TH & 17TH FLOOR PLAN  
18TH FLOOR PLAN

### UNIT A (TOWER A)

### UNIT G (TOWER C)

AMENITY DECK FLOOR PLAN





**ONE** PACIFIC RESIDENCE  
MACTAN ISLAND

## 1-BEDROOM

A=53.8 SQ.M.

BALCONY=2.8 SQ.M.

### UNIT F & M (TOWER A,B&C)

TYPICAL 7TH, 9TH, 11TH, 14TH & 16TH FLOOR PLAN

TYPICAL 8TH, 10TH, 12TH, 15TH & 17TH FLOOR PLAN

18TH FLOOR PLAN

### UNIT J (TOWER A)

### UNIT C,F (TOWER B)

### UNIT E (TOWER C)

AMENITY DECK FLOOR PLAN





**ONE** PACIFIC RESIDENCE  
MACTAN ISLAND

## **1-BEDROOM**

**A=41.9 SQ.M.**

**BALCONY=2.7 SQ.M.**

**UNIT B,C,D,E,I,J,K&L (TOWER A,B&C)**

**TYPICAL 7TH, 9TH, 11TH, 14TH & 16TH FLOOR PLAN**

**TYPICAL 8TH, 10TH, 12TH, 15TH & 17TH FLOOR PLAN**

**18TH FLOOR PLAN**

**UNIT B,C,D,G,H,I (TOWER A)**

**UNIT B,E (TOWER B)**

**UNIT B,C,D,H,I (TOWER C)**

**AMENITY DECK FLOOR PLAN**





**ONE** PACIFIC RESIDENCE  
MACTAN ISLAND

## **EXECUTIVE STUDIO**

**A=38.5 SQ.M.**

**BALCONY=2.9 SQ.M.**

### **UNIT G & N (TOWER A,B&C)**

**TYPICAL 7TH, 9TH, 11TH, 14TH & 16TH FLOOR PLAN**

**TYPICAL 8TH, 10TH, 12TH, 15TH & 17TH FLOOR PLAN**  
**18TH FLOOR PLAN**

**UNIT K (TOWER A)**

**UNIT G,D (TOWER B)**

**UNIT F (TOWER C)**

**AMENITY DECK FLOOR PLAN**





ONE PACIFIC RESIDENCE  
MACTAN ISLAND

## 1-BEDROOM

A=42.9 SQ.M.

BALCONY=2.7 SQ.M.

**UNIT E,F (TOWER A)**

**UNIT A (TOWER B)**

**UNIT A (TOWER C)**

**AMENITY DECK FLOOR PLAN**





## Amenities:

Size of Swimming Pool

Lap Pool- 186 sqm  
Aqua Gym Pool-55.5 sqm  
Children's pool-25. 2 sqm

Location of Swimming pool

6<sup>th</sup> floor Amenity Deck

Depth of Pool:

1.5 m

Location of Access of to Amenity Area

Ground floor Residential Entrance Lobby





**Other Amenities, Services and Locations:**

Tennis Court, Wall Climbing, Adult Fitness Station, Jogging path, Yoga/Taichi Area, Outdoor Lounge Gym, Culinary Station







**Other Amenities, Services and Locations:**

Tennis Court, Wall Climbing, Adult Fitness Station, Jogging path, Yoga/Taichi Area, Outdoor Lounge Gym, Culinary Station





ONE PACIFIC RESIDENCE  
MACTAN ISLAND



**For Viewing Appointments and More Information's,**

Please Call:



Alfred Mariblanca Ybañez Solitario

Reals Allied and Partnership Company

Real Estate License No. 5381

Websites:

[www.realsalliedrealty.weebly.com](http://www.realsalliedrealty.weebly.com)

[www.realsallied.com](http://www.realsallied.com)

[www.2k1starrealty.weebly.com](http://www.2k1starrealty.weebly.com)

[www.alfredsolitario2009.multiply.com](http://www.alfredsolitario2009.multiply.com)

Mobile Numbers:

Globe: +63915.452.9931

Sun: +63932.865.2976

Smart: +63929.283.2345

Viber #: 0917.327.6415

Office Number: +63.32.580.8304

E-Mail Add: [alfredsolitario2009@gmail.com](mailto:alfredsolitario2009@gmail.com)

YM: [alfred\\_solitario2006@yahoo.com](mailto:alfred_solitario2006@yahoo.com)

Member Organizations:

Delta Phi Epsilon (Delphians) - [USC-TC](#) Campus Chapter

"Reals Allied Realty. Beyond the sale"